

Consent Record Types

Last Modified on 08/12/2021 9:33 am EDT

Version 14.19



This window map article points out some of the important aspects of the window you're working with in OP but is not intended to be instructional. To learn about topics related to using this window, see the **Related Articles** section at the bottom of this page.

About Consent Record Types

Path: Practice Management tab > More button (Reference Data group) > Consent Record Types

The Consent Record Types window lists and modifies consent record types. These consent record types are linked to the Document Type fields for scanned consent forms when attaching the consent forms to individual patient records. This window determines if a consent record type is active or inactive.

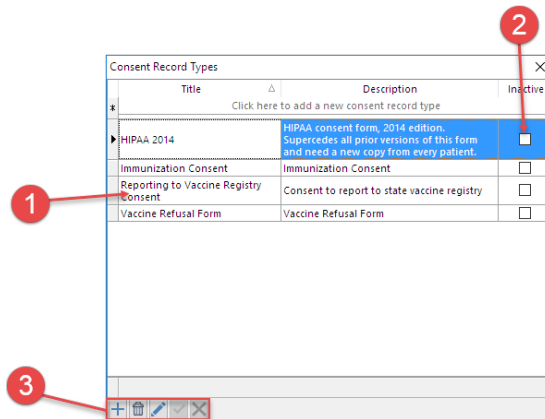

Consent Record Types Map

Number	Section	Description
1	Consent Record Types	The Consent Record Types lists the names and descriptions for the consent record types. Enter the title and description of the consent record type here.
2	Inactive	The Inactive checkbox indicates if a consent record type is active or inactive. If the Active checkbox is selected, then the consent record type is considered inactive.
3	Function Buttons	The function buttons add a record type, delete a record type, edit a record type, save changes, and cancel changes.

Version 14.10

About Consent Record Types

Path: Utilities Menu > Manage Codes > Consent Record Types (Keyboard Shortcut keys: [Alt][U][C][T])

The Consent Record Types window lists and modifies consent record types. These consent record types are linked to the Document Type fields for scanned consent forms when attaching the consent forms to individual patient records. This window

determines if a consent record type is active or inactive.

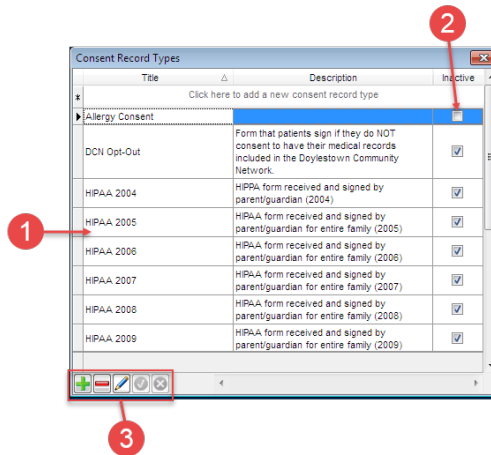

Consent Record Types Map

Number	Section	Description
1	Consent Record Types	The Consent Record Types lists the names and descriptions for the consent record types. Enter the title and description of the consent record type here.
2	Inactive	The Inactive checkbox indicates if a consent record type is active or inactive. If a checkmark is selected in the the checkbox, then the consent record type is considered inactive.
3	Function Buttons	The function buttons add a record type, delete a record type, edit a record type, save changes, and cancel changes.